

BNI

FEATURES

- Accuracy for center inner diameter guaranteed to 0.003.
- Accuracy after point locking guaranteed to 0.005
- Excellent for versatile production by changing insert shafts quickly.
- Heat-treated point to HRc 60 ± 2.
- 6 types of standard point is available.
- Because of the insert shafts, the admissible workpiece weight is limited.
- Mounting taper of point is 1/10 degree.
- Order made special shape point is available.

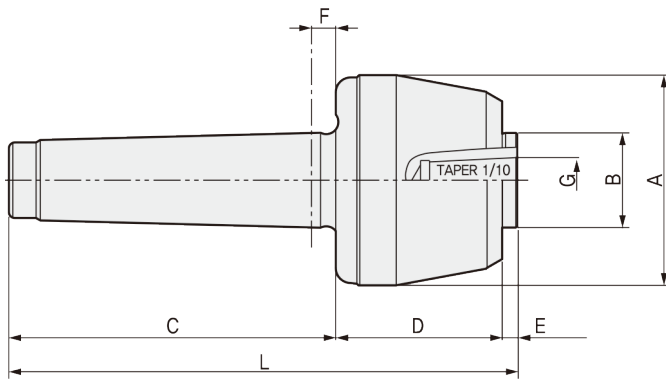

Dimension

Unit: mm. kg

MODEL	MT	A	B	C	D	E	F	K	L	Workpiece Weight	Max, R.P.M	Weight	Max, Run Out
051002	2	50	25	68	43.5	5	6	12	116.5	80	5,000	0.6	0.005
051003	3	50	25	85	43.5	5	6	12	133.5	150	5,000	0.8	0.005
051004	4	69	32	108	55	5	8	15	168	250	3,800	1.7	0.005
051005	5	88	40	136	70	6	8	22	212	650	3,000	3.9	0.005

* Order example : '051004 Body' = MT4 BNI body only (without an insert shaft)
 '051004 SET' = MT4 BNI body and 6 insert shaft included

BNItype Technical data

- 2BNI
- 3BNI
- 4BNI
- 5BNI

