

WPL30A

FEATURES

- Accuracy guaranteed to 0.003mm TIR (0.0001")
- Excellent for CNC, grinder and inspection machines.
- Waterproof enhanced type.
- Heat-treated point to HRc 60 ± 2.
- Small head diameter reduces interference problem between tool holders and turning tools.
- Carbide point available.
- Carbide point to HRA 90 ± 5.

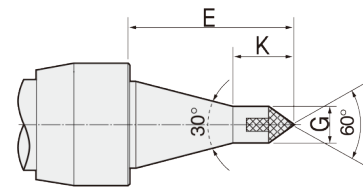
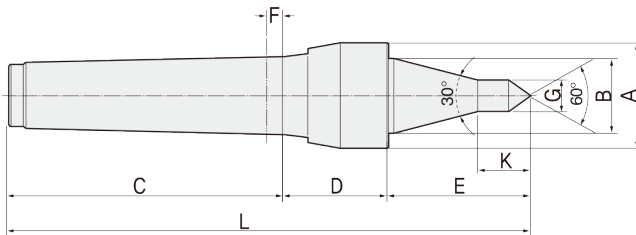

Available Carbide Tipped Points WPL30AC-TYPE

- MT2: 076002
- MT3: 076003
- MT4: 076004
- MT5: 076005

Dimension

Unit: mm. kg

| MODEL | MT | A | B | C | D | E | F | G | K | L | Workpiece Weight | Max. R.P.M | Weight | Max. Run Out |
|--------------------|----|------|------|-----|----|-----|-----|------|----|-----|------------------|------------|--------|--------------|
| 075002 (076002) | 2 | 27.7 | 23.8 | 69 | 28 | 42 | 4.5 | 10 | 14 | 139 | 100 | 4,000 | 0.3 | 0.003 |
| 075003 (076003) | 3 | 32.3 | 28 | 85 | 32 | 50 | 5 | 10 | 14 | 167 | 280 | 3,000 | 0.5 | 0.003 |
| 075004 (076004) | 4 | 45 | 40 | 108 | 48 | 80 | 6 | 12.5 | 24 | 236 | 500 | 3,000 | 1.2 | 0.003 |
| 075005 (076005) | 5 | 62 | 54 | 136 | 54 | 110 | 8 | 12.5 | 24 | 300 | 900 | 2,000 | 3.2 | 0.003 |

* (MODEL NO) : Carbide Tip Type

WPL30A type Technical data

- 2WPL30A
- 3WPL30A
- 4WPL30A
- 5WPL30A

